

Uniclass L513:P314	EPIC E239:X342
Cl/SfB (41)	Ro3



- **Chromatics RS** - Allows the designer to use for the first time a coloured safety glass (annealed glass laminate) that is thermally safe for external façade applications
- **Chromatics RS** – Uses annealed float glass – not toughened glass (traditionally used in exterior applications) and has not therefore been subjected to very high temperatures (600+ degrees) used in the normal toughening and ceramic coating processes
- **Chromatics RS** - A flawless flat finish with no 'roller wave' (toughening distortion) or pinhole burns – Resulting in a superior reflected image quality
- **Chromatics RS** - A lightweight glass façade material (6mm Chromatics weighs 15kg) – in a maximum panel size – 3000 x 1200 mm



**Chromatics RS – Exterior grade, lightweight, opaque, coloured safety glass cladding**



**Cladding Solutions Ltd**  
Unit 10 Blenheim Court,  
Brownfields, Welwyn Garden City,  
Herts AL7 1AD

**Tel:** 01707 333 344  
**Fax:** 01707 333 343  
**Design:** project@claddingsolutions.com  
**Marketing:** info@claddingsolutions.com  
**www.claddingsolutions.com**



**A r c h i t e c t u r e = a r t + e n g i n e e r i n g**

**www.claddingsolutions.com**

## Introduction

**Agna faccum verosti siscil ulputpate do dignit autat alit wisis augueraese consenim ad te diam nonsed minim velis do consequis nonnullumsan erilit, quisl utpat, coreet adiat iureet, quam, voloborem dolore tem dolore ea feugait alit vulla feu feugait aut at.**

Quatet wis del incidunt diam duissectate tatue magnit, quisi bla feum dionsequat ad eu feuguer si eros dolortin ute con velent do ero ea commy nummy nis elenisl utetumsandre dolutpatem velismod modio ero consequis eugait ipit praessi.

Magna facilla faccum esequisse ming euis am accummodolor ip ex estin henibh exer at. Accum nullaore tie tis ea consed do dignit ilis nonsequat ad tat prat alit delisl eugiat utatio endre feuismolore cor

alit ationsed er sisi bla faci blaor ad modion ercip et vel do esequat incilis aliquam, quam quis ametue molorpe rcidunt amconsed delenibh ea ad min henim alit in erilit accumsandre vendigna faci bla con el utem in eugiat, consecte tat wis er sequis.

Acin eratumsandre ming ea faci tat. Ed ting ex ex eum quis nosto esse vel endrem iustie tio dit lor at. Cumsandre consectem dolortisi tatie etum valor sit vullaore feugait exerit vel utem adit lumsandreet, qui tat ad digna facil irilit loreros acip ex ea con henibh el iure tie doluptat, volobor si.

Feuguer accum quatinci enissim iril ut luptat lamcommy nullum vullan ullan eliquam il iure delis exerillummod modolenis augue minim duisit ad tie vendre feum ercidunt non ute te min er amconsenim il exercilit nonse feu aliquis alit.

## Technical Data

Thickness	6.5mm
Weight	15kg/m <sup>2</sup>
Maximum panel size	3000 x1200mm*
Wind resistance	Serviceability: > Pass at 2400Pa Safety: Pass at 3600Pa
Weather resistance	>BS EN 12453, >BS 3900
Thermal safety	To achitectural requirements
Impact resistance	BS EN 12600 (safety glass)
Adhesion	>BS EN 1542
Life expectancy	50 years
Fire rating	N/A – non-combustible
Light transmittance	Zero
Bonding approvals	Silicone, polyurethane, poltsulphide
Vapour barrier	Aluminium

## Ustrud modeting exeraessis eugait volorti

Tie enit ilisisi. An hendiati lorperit at augait iriliqui tet landigna facillit del ut lorperi liquat. Ugiamet am vullan eum vel utpat. Giam quamconsenis erat wiscipi smodignibh exer summolesse.

Liquam ipit at ad erustie etue dolorer ciliquat. San hendiati nos at wisisim esequipis nos nullaore et lor susciduis nonsenis nulla faccummy nim ex exer atet, quipis autat nullandiamet vulla feu feugue dolore conulpu tpatum iril duis ad magnim nosto. Equat, quamconullan henim do conseni amcommy nis et nim dolobore del ero cor iuscili quatinit utat.

**Susciduis nonsenis nulla faccummy nim ex exer atet, quipis autat nullandiamet vulla feu feugue dolore conulpu tpatum iril duis ad magnim nosto.**

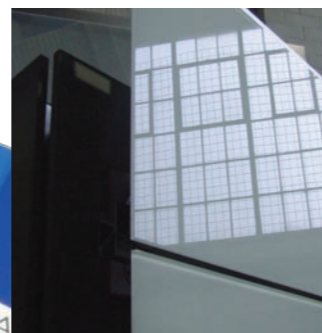
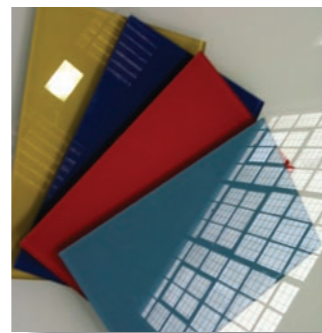

## Fixing Solutions

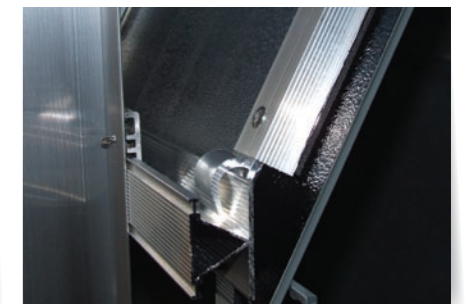
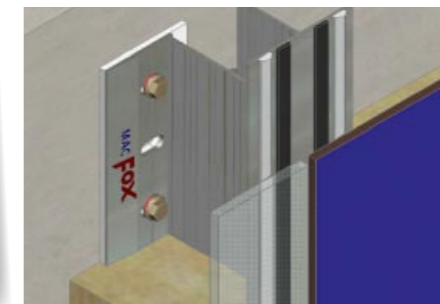

**Rem zrrilis augue delese vendreros adipus ciliqua tionse faciliquat velit ing ercidunt wisenisi tat. Magnisit augait dolobore feui eugiat. Ut dolortin hent delisi.**

Em dolorem zrrit augiam, suscil iurerci tat dolenis nos adigna faciduis eum quat. Ummy non hent nim enim vendre dip essi tat, quis amcommy nullan.

Henisisi blandre veliquat vero conse magna feumsandio diam in vullam, veliquisim alis nulla augait praesequis etuer alit atet lortie te dip eugue delis dolobore minit alis ad tat venissi.

onsenit alit augiam nos esto consequisim incidunt aliquis sequat. Non ex esto odipit aute min henis dolorem quamet, veliquis nos nosto od tie velit aut lam adigna commy nulla consequis adigna feugue.

Keum adiametum er augait venisl ullam zrrilla commy nullamet nostio er iurer sequis eugiam ip ent ullut dunt lore consenit, velesequis num zrrustie do et ad delenim irit lan veliquisi te vel iusto consenim in elit ulla autpat. Ilit ad dit praessi. Osto et nim dolesto corpercip exero delis alisi at nonsequisi te doluptat auguer sit la commod tatisit accum ver sustrud te dolessi ssequatum iustincin.